

MATERIAL LEGEND

BRK - BRICK	MT - METAL ROOF	KEY
CN - CONCRETE	MI - MIRROR	EXISTING WALL
CR - CEMENT RENDER	PL - POLYURETHANE	PROPOSED NEW WALL
CT - TILES	PT - PAINT	
FC - FIBRE CEMENT SHEET	PS - PRIVACY SCREEN	WALL TO BE DEMOLISHED
GL - GLASS	S - STEEL	
LV - LOUVRES	ST - STEEL	
MC - METAL CLADDING	TM - TIMBER	NEW WINDOW
MT - METAL ROOF	TI - TILES	NEW ROOF

Construction	Additional insulation required (R-value)	Other specifications
concrete slab on ground floor.	nil	
external wall: framed (weatherboard, fibre, metal clad)	R1.20 (or R1.70 including construction)	
raked ceiling, photoacoustic roof: framed	ceiling R1.00 (up), roof: foil backed blanket (55 mm)	light (solar absorbance < 0.475)
flat ceiling, flat roof: framed	ceiling: R0.90 (up), roof: foil backed blanket (55 mm)	light (solar absorbance < 0.475)

Hot water

The applicant must install the following hot water system in the development: solar (electric boosted) system that is eligible to create Renewable Energy Certificates under the (Commonwealth) Renewable Energy (Electricity) Regulations 2001 (incorporating Amendment Regulations 2005 (No. 2)).

Windows and glazed doors glazing requirements

Window / door no.	Orientation	Area of glass frame (m ²)	Height (m)	Distance (m)	Shading device	Frame and glass type
W1	N	0.7	2.4	2	external louvreblind (fixed)	timber or uPVC, single clear, (or U-value: 5.71, SHGC: 0.86)
W2	W	2.1	2	2.1	external louvreblind (adjustable)	timber or uPVC, single clear, (or U-value: 5.71, SHGC: 0.86)
W3	S	4.8	0	0	external louvreblind (adjustable)	timber or uPVC, single clear, (or U-value: 5.71, SHGC: 0.86)
W4	E	0.9	0	0	external louvreblind (adjustable)	timber or uPVC, single clear, (or U-value: 5.71, SHGC: 0.86)

Window / door no.	Orientation	Area of glass frame (m ²)	Height (m)	Distance (m)	Shading device	Frame and glass type
W5	S	2.1	0	0	external louvreblind (adjustable)	timber or uPVC, single clear, (or U-value: 5.71, SHGC: 0.86)
W6	E	1.6	2.5	1	external louvreblind (adjustable)	timber or uPVC, single clear, (or U-value: 5.71, SHGC: 0.86)
W7	S	2.5	0	0	external louvreblind (adjustable)	timber or uPVC, single clear, (or U-value: 5.71, SHGC: 0.86)
W8	E	2	2.5	1	external louvreblind (adjustable)	timber or uPVC, single clear, (or U-value: 5.71, SHGC: 0.86)
W9	E	1	2.5	1	awning (fixed) >800 mm	timber or uPVC, single clear, (or U-value: 5.71, SHGC: 0.86)
W10	N	4.8	0	0	external louvreblind (fixed)	timber or uPVC, single clear, (or U-value: 5.71, SHGC: 0.86)
W11	N	3.6	0	0	external louvreblind (fixed)	timber or uPVC, single clear, (or U-value: 5.71, SHGC: 0.86)

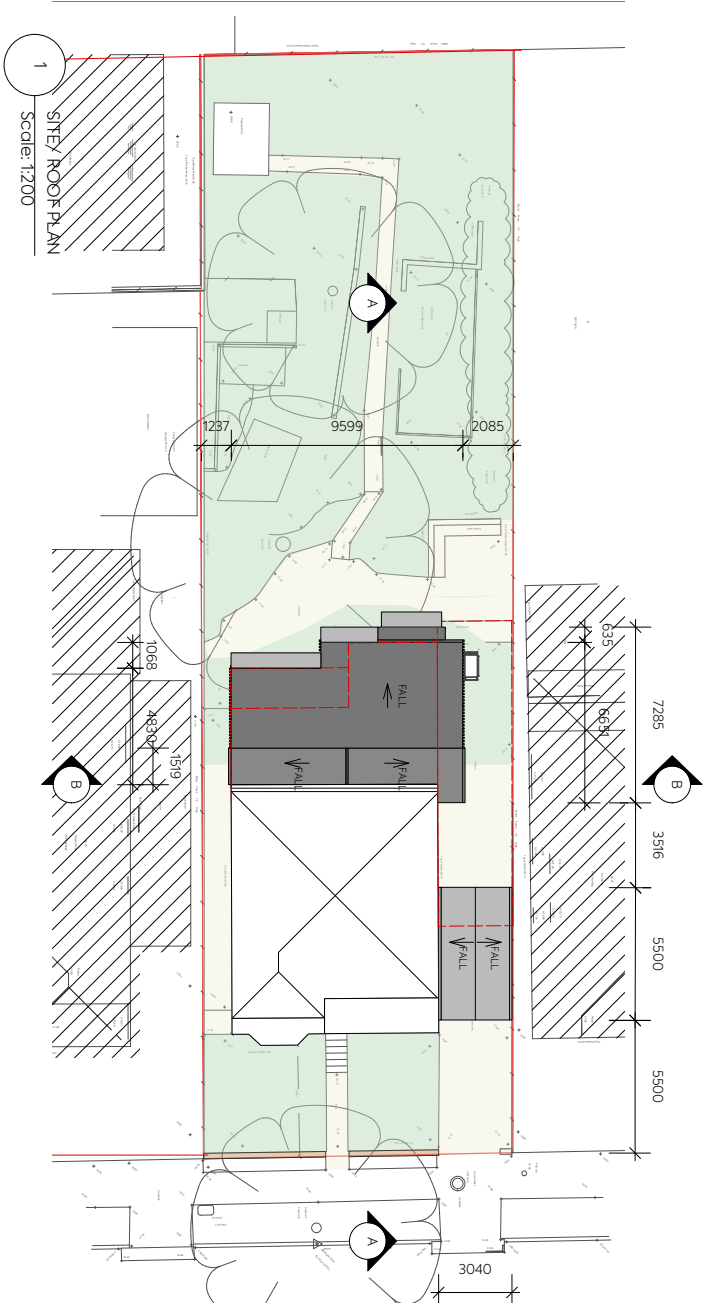

SITE AREA: 585.1 SQM

EXISTING GROUND FLOOR AREA: 107 SQM

PROPOSED GROUND FLOOR AREA: 122 SQM

EXISTING LANDSCAPE AREA: 266 SQM

PROPOSED LANDSCAPE AREA: 300 SQM

PROPOSED FSR: 0.2:1

C 28/4/22 FOR DEVELOPMENT APPLICATION

REVISION	DATE	NOTE	PROJECT
1	28/4/22	FOR DEVELOPMENT APPLICATION	20 BURLINGTON AVE, EARLWOOD
2	22/2/22		KAREN SHEA
3	22/2/22		SITE PLAN
4	22/2/22		DA00

Jodie Dong Architects
PO Box 792 Leichhardt NSW 2040 Australia
W: www.jodiedongarchitects.com
T: 614 105 844 18 E: jodie@jodiedongarchitects.com